

NUGA

www.nuga.kr

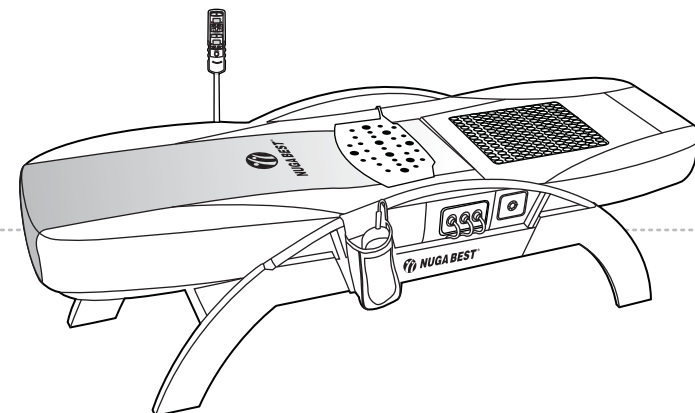

NM-5000



User Manual

Thank you for purchasing this product.
Before use...
Please read the cautions for safety in the
user manual to use this product safely.

Quality Warranty Enclosed

Tourmanium Product

 **NUGA MEDICAL CO.,LTD.**

 185, Jiraeul-ro, Jijeong-myeon, Wonju-si,
Gangwon-do, Korea

TEL : +82-33-730-0001 / FAX : +82-33-730-0007

<http://www.nuga.kr>



ENGLISH / CE H/H / Rev. 08
2015.11.10

 **NUGA MEDICAL CO.,LTD.**

Product Introduction

Product features	8
Guide and Sequence for Product Installation	9
Product Components	10
Product Frame Components	11
Tray with Screws for Assembly	12
Names and Functions of Product Components	14
Descriptions for Remote Controller Buttons	16

Product Installation and Preparations

Before the Product Installation	18
How to Assemble the Product Frame	20
How to Install the Product	24
Test Operations after Installation	26

How to Use the Product

How to Use the Remote Controller	28
How to Use the Product by Mode	28
How to Use the External Projector	33
How to Use the Low Frequency Pad	34
How to Use the Product	36
How to Set Temperature for the Sub Heater	38

Product Storage and Care

How to Store and Clean the Product after Use	40
Check Indicator Window of Remote Controller	41
How to Take Emergency Actions during Use	42
Self-check Items	43
Before any A/S Request	44
Product Specifications	45
Memo	46
Product Warranty	47

Cautions for your safety

- These cautions include descriptions for the safety of users and prevention of any damage to properties among others.
- Read through the following details to use the product appropriately.
- This Manual classified the risk level into the following three degrees and the following graphical symbols aim to remind users of cautions for matters and operations of concerns about any risk.

Interpretations on symbols



Danger
If there is high possibility of death due to non-compliance.



Warning
If there is a possibility of an injury or death due to non-compliance.



Caution
If there is a possibility of a minor injury or damage to goods due to non-compliance.

Disclaimer

- The manufacturer, importer and/or agent shall not be responsible for any problem and/or other damage to the product which has been caused from the user's careless care or operation.
- Information in the user manual has been prepared on the basis of the current product specifications.
- Details on the user manual might be different from those on the product.
- The product manufacturer is adding and supplementing new functions at any time and new technologies shall be applied to the product continuously in the future as well.
- All the standards and functions are subject to change without any notice to users to improve performance.

Danger



Put the projector cover on the projector while using the projector to keep the projector from touching the skin directly. (Otherwise, it is likely that injuries occur.)

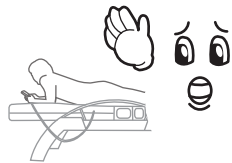

Ensure applying the product only abdominal area manually, while keeping the product from applying to the area around ribs if you have to apply the product to the abdominal area.



Avoid applying the projector directly to eyeballs to prevent from any risk. (Otherwise, it might cause damage to eyeballs.)

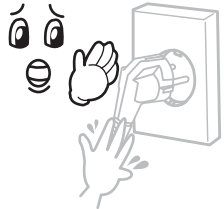

Avoid pulling out the power cord parts or touching the power plug with the wet hand. (Otherwise, it might cause the electrical shock or fire.)

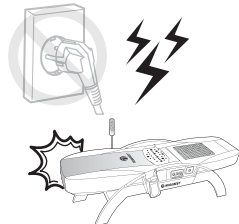

Immediately stop using the product and turn off the power if there is any thunder, lightning or earthquake. (Otherwise, it might cause the electrical shock or fire.)

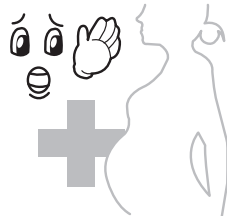

Prohibit any pregnant woman near the parturition, patients with rachischisis, patients wearing a cardiac pacemaker and/or patients with severe heart diseases from using the product.



Avoid using the product in a closed place with any fuel and/or chemical. (Otherwise, it might cause injuries or fire.)

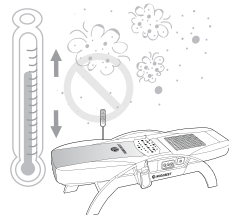

Avoid using the product in a place with a great deal of dusts or intensive temperature change. (Otherwise, it might cause the electrical shock or fire.)



Anyone other than technicians qualified for our company's A/S shall not disassemble, repair or modify the product by any means. (Otherwise, it might cause damage to the product or electric shock and/or fire.)

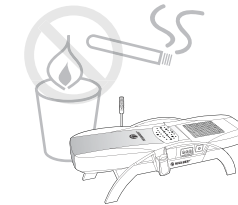

Avoid placing inflammable substances like candlelight, cigarette light or liquors and/or vessels containing water, heavy objects or other objects on the product. (Otherwise, it might cause fire.)

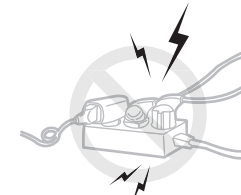

Do not insert many power plugs for other products into a socket to be used simultaneously. (Otherwise, it might cause electric shock, injury and/or damage to the product.)



Avoid twisting the body while the internal projector is being operated. (Otherwise, it might cause excessive influences to the spine.)

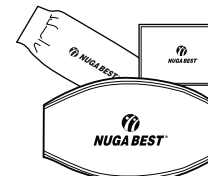

Avoid using any band or belt that does not come as one of components from the purchase of the product. (Otherwise, it might cause damage to the product.)



Apply the product to the area with any surgery and/or treatment, after consulting with the store or the company from which you have purchased the product.

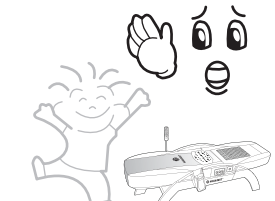

Do not allow any child to use the product alone.

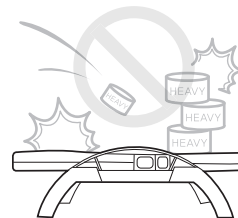

Avoid jumping on the product or any other action to provide shocks to the product. (Otherwise, it might cause injuries and/or damage to the product.)

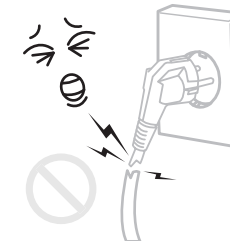

Use the product after checking out any damaged or worn-out cord. (Otherwise, it might cause electric shock, injury and/or damage to the product.)



Avoid bending the power cord excessively or pressing it down with heavy objects.

 **Caution**

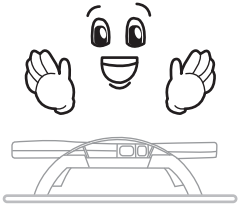

Install the product horizontally.



Please abide by using time and methods.

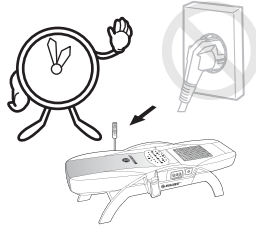

Separate the power cord while the product is not being in use for a long time.

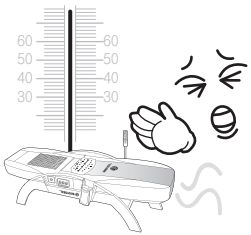

Use the product in a range of proper temperature as there are concerns of burns if the higher temperature is set.

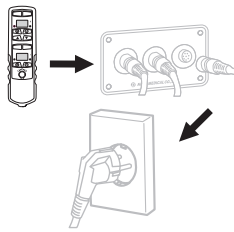

Connect the power supply after connecting the remote controller first.



Be aware of dangers that you might fall down when you get on or off the product.

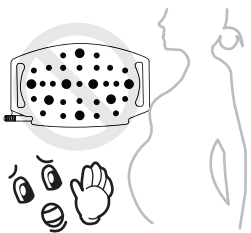

Any pregnant shall not use the low frequency pad.

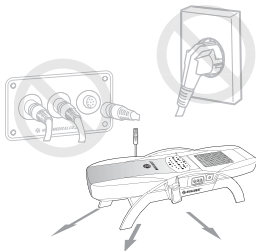

Move the product after separating the power supply from connecting lines if the product is moved.

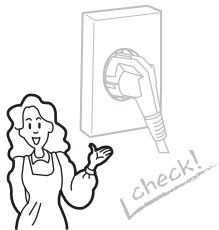

Check out the applied voltage before any use and apply the power plug only to a dedicated socket.

NM-5000

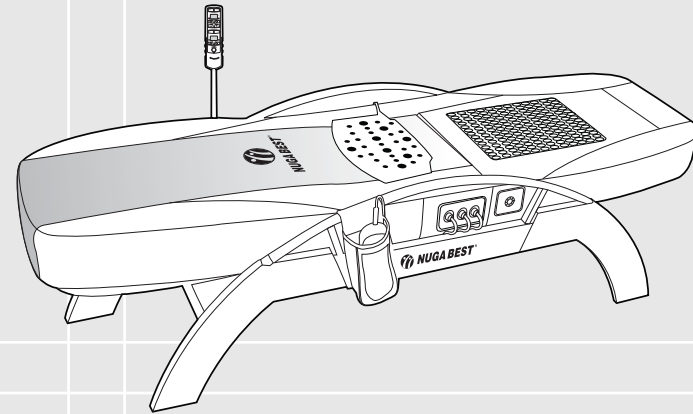

Product Introduction

Product features	8
Guide and Sequence for Product Installation	9
Product Components	10
Product Frame Components	11
Tray with Screws for Assembly	12
Names and Functions of Product Components	14
Descriptions for Remote Controller Buttons	16

Fine Design

- ① The design in a streamline shape makes you feel comfortable during use.
- ② Beautiful materials with good feelings of touch in high quality are applied.
- ③ The product in blue helps you improve concentration and psychological stability.

Functional Product Frame

Both the main mat and sub mat are horizontally built, which can be used more conveniently with the attachment of a handle to be controlled in 3 steps respectively for the desired angle of 10°, 20° or 30°.

Internal Projector Designed in Human Engineering

Ceramics are separately built in around the cervical vertebrae as the acupressure load can be equally distributed due to the design that the internal projector can be rotated in a certain angle to the up/down/left/right.

Conveniently Designed External Projector

External projector is designed in a size conveniently held and used with a hand, which can be stored in a projector pocket nicely during no use.

Internal Driving Method with Low Noises

There are few noises thanks to the minimized friction between the internal projector and rail due to the specially designed guard rail which can be used semi-permanently by minimizing the driving load.

Convenient Remote Controller Holder

The remote controller holder possible of 360° rotation can be used conveniently in any desired angle by the user.

Multifunctional Remote Controller Integrated into One

Buttons in a size that can be identified at a glance are easy to use with less wear due to the special materials, and button descriptions cannot be easily erased.

Special Heater and Tourmanium

The tourmanium mat is combined to the special heater.

1 How to refer to cautions for safety

Refer to cautions to be kept during the product use.
(Refer to Page 3 in this User Manual for more details.)



4 How to Install the Product (Refer to Page 24 in this User Manual for more details.)

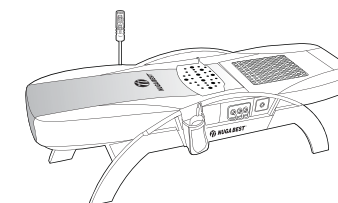

2 How to check out the product components (Refer to Page 10 in this User Manual for more details.)

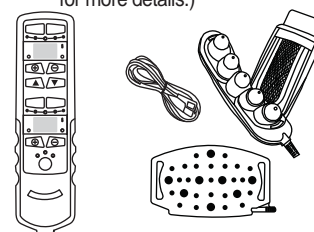

5 How to use the product (Refer to Page 28 in this User Manual for more details.)

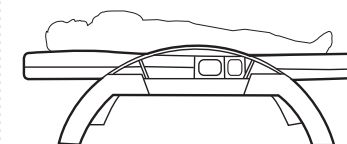

3 How to Assemble the Product Frame (Refer to Page 20 in this User Manual for more details.)

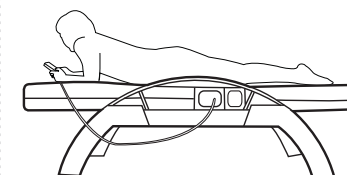
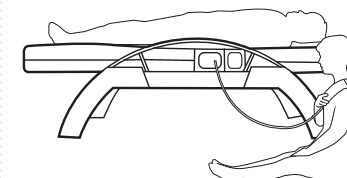
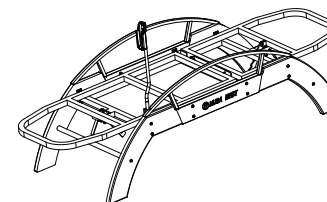

Product Components

Product Frame Components

i Introduction

Please check out whether all the components are in hand before installing the product.
Please inquire of your supplier if there is any missing or damaged component.
Some specifications and/or designs are subject to change for improving the product performance.

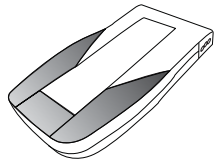

Main mat

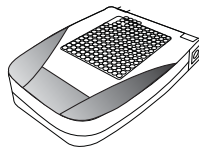

Sub mat

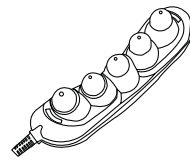

External projector

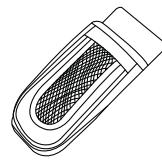

Projector pocket

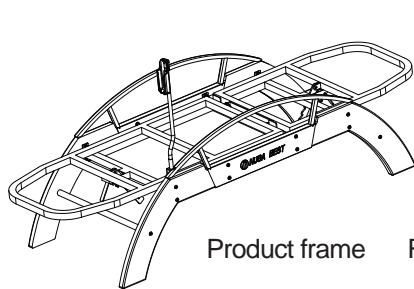

Product frame



Remote controller



Remote controller holder
(included in the frame
packing box)



External cloth

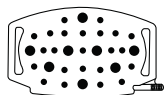

Low frequency pad



Abdominal band for
low frequency pad



Towel for low
frequency pad



Projector covers

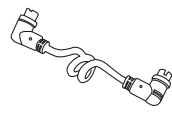

Connection cable
for sub mat



Power cord



User manual

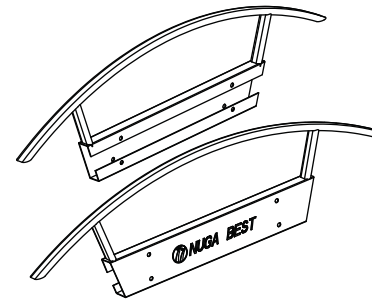

Handle frame(2EA)

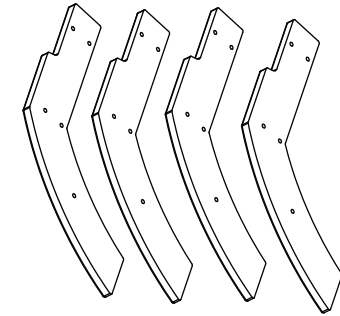

Frame legs(4EA)

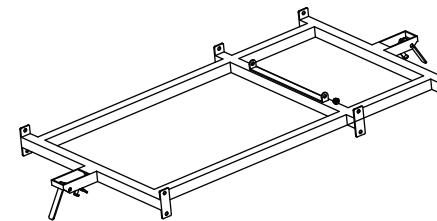

Main base frame

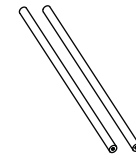

Frame leg fixing pipe

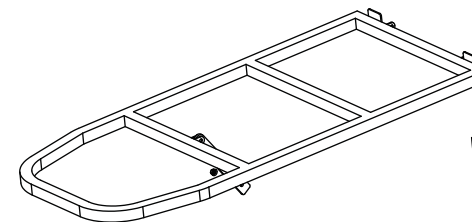

Main angle frame

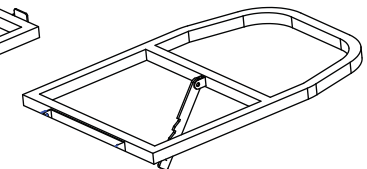

Sub angle frame

Screws and components for assembly

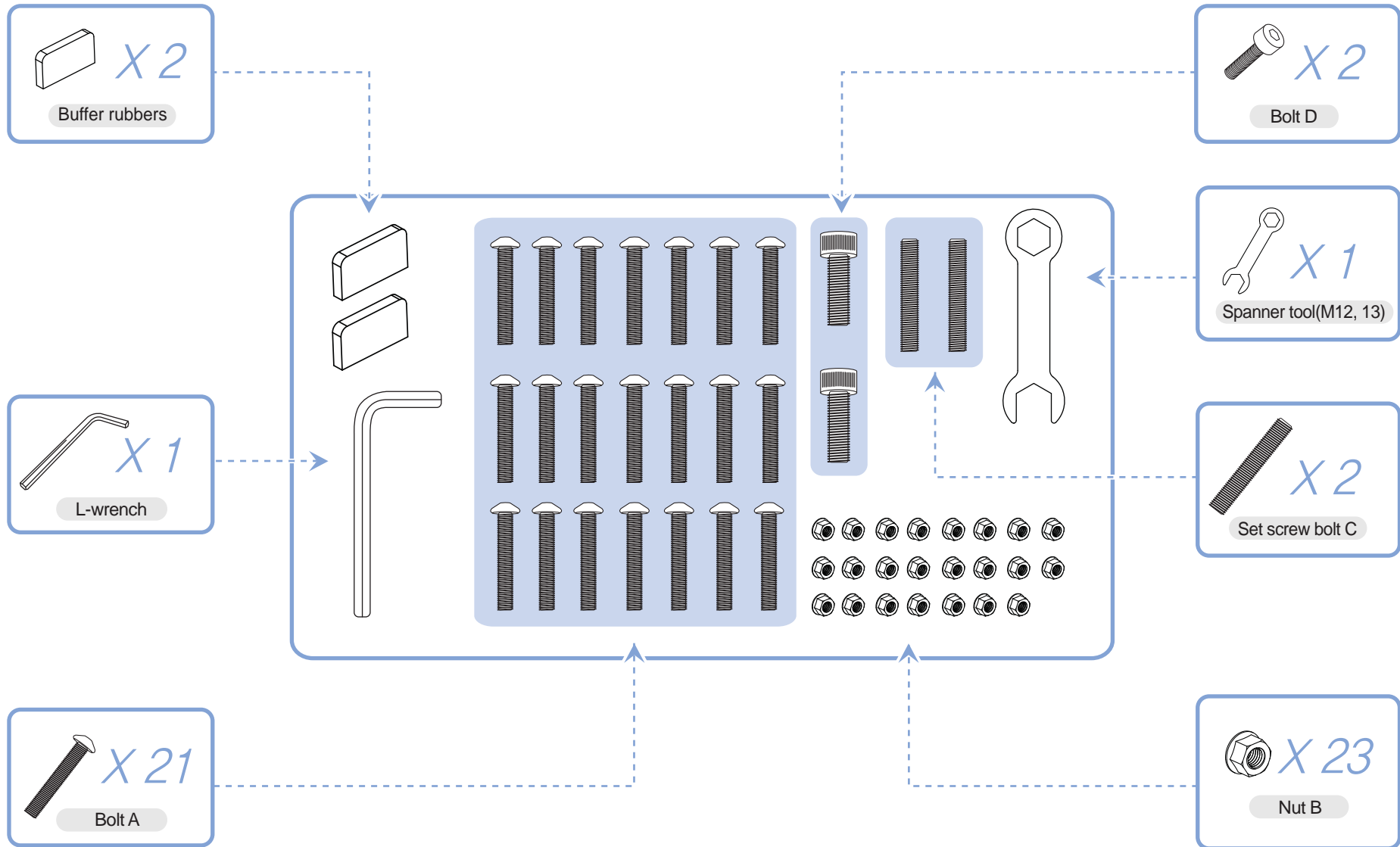

Names and Functions of Product Components

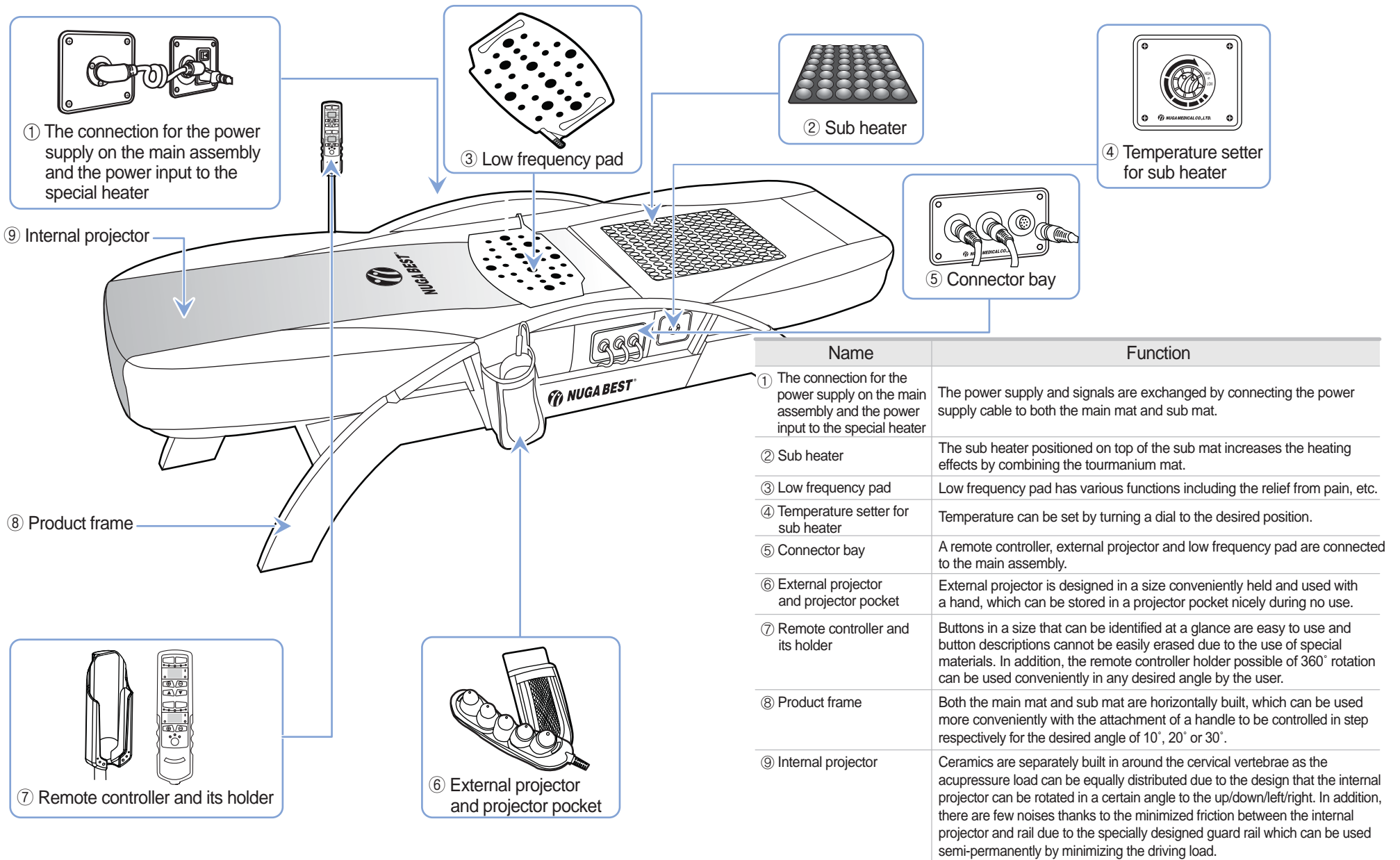

Descriptions for Remote Controller Buttons

POWER Power button
Button to turn on/off the power supply for the product and internal projector

AUTO Auto/Manual Switch Button
Button to set the operating mode for the internal projector to Auto/Manual

Button to set the operating mode for the internal projector to Auto/Manual

45 Window to display temperature and error message of internal projector (refer to Page 41 for error messages)

Temperature Control Button for Internal Projector
Button to increase or decrease temperature of internal projector

Manual Mode Button for Internal Projector
Button to adjust the position of internal projector up/down during the manual mode setting

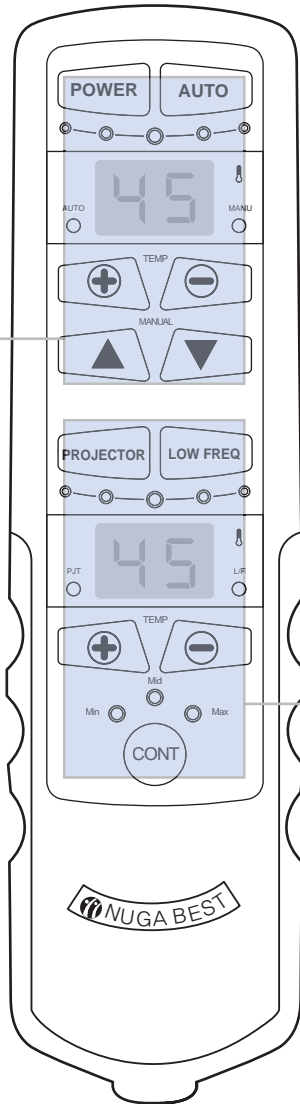

PROJECTOR Power Button for External Projector
Button to turn on/off the power supply for the external projector

LOW FREQ Power Button for Low Frequency Pad
Button to turn on/off the power supply for the low frequency pad

45 Indicator Window for Temperature and Condition of External Projector
Window to display temperature and error message of external projector (refer to Page 41 for error messages)

Temperature Control Button for External Projector
Button to increase or decrease temperature of external projector

Button to control the strength of low frequency
Button to control the strength of low frequency to a range of strong ~ weak in the low frequency pad

NM-5000

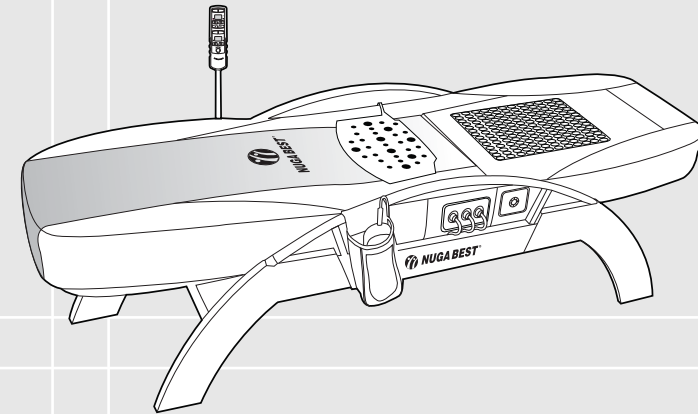

Product Installation and Preparations

Before the Product Installation	18
How to Assemble the Product Frame	20
How to Install the Product	24
Test Operations after Installation	26

Before the Product Installation



Install the product in a flat floor.
Otherwise, it might damage the product.

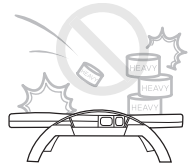

Do not drop or shock the product.
Otherwise, it might damage the product.

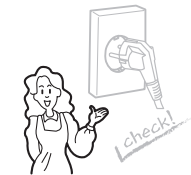

Check out the applied voltage before any use.
Otherwise, it is likely that the electrical shock
or fire occurs.

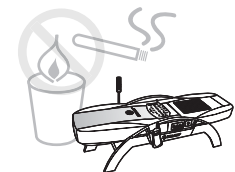

Do not place any inflammable substance on the
product, such as candle light or cigarette light.
Otherwise, it is likely to cause the electrical
shock or fire.



Avoid using the product in a closed place
with any fuel and/or chemical.
Otherwise, it might cause injuries or fire.

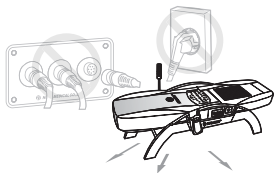

Move the product after separating the
power supply from connecting lines if the
product is moved.

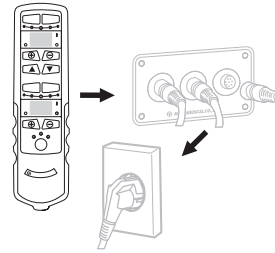

Connect the power supply after connecting
the remote controller first.
Otherwise, it might cause damage to the product.

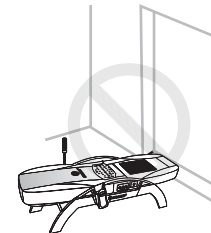

Do not install the product in a place with the
frequent access.
(Otherwise, the product might be damaged.)

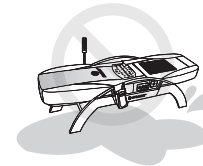

Do not install the product in a place with
much moisture or water.
(Otherwise, the product might be damaged.)

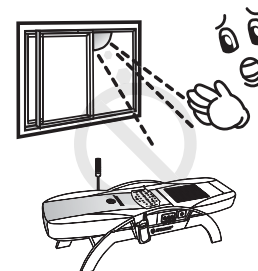

Be careful not to expose the product to the
direct sunlight.
(Otherwise, the product might be damaged.)

How to Assemble the Product Frame

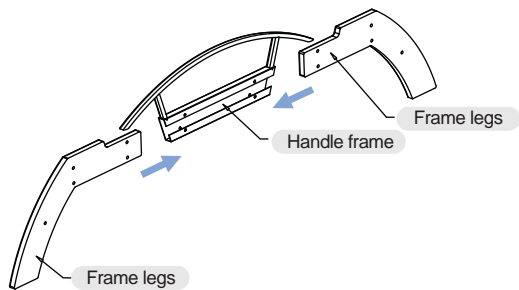

1 How to connect frame legs to the handle frame.
Insert frame legs (2 pieces) into the handle frame as shown in the picture.
Please note that the instructed corner direction should be oriented to the same direction during the insertion.
Assemble frame legs and the handle frame in the same way.

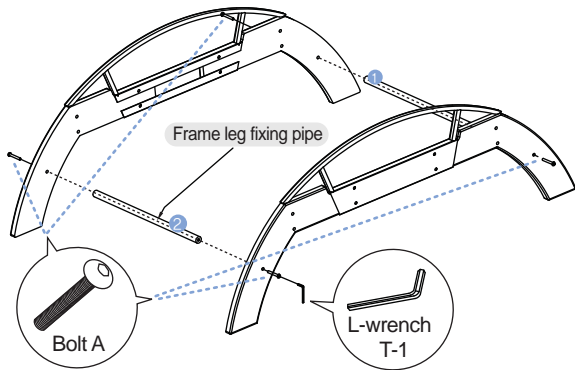

2 How to fix frame legs.
Fix 2 pieces of frame leg fixing pipes with 4 pieces of bolt A as shown in the picture and then fix it with a piece of L-wrench (T-1).
Do not fasten bolts completely here.

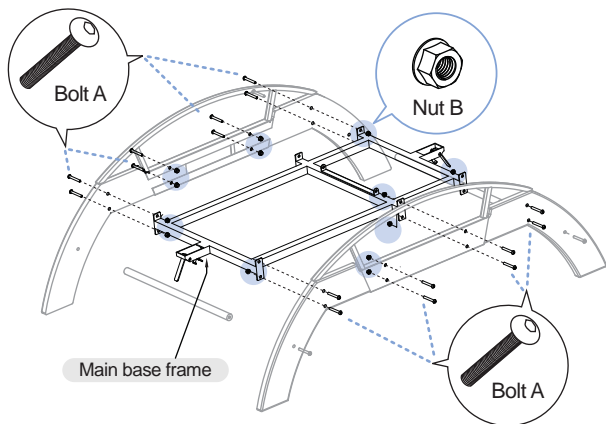
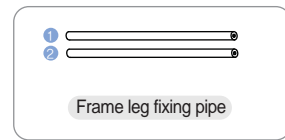

3 Main base frame
Fix the main base frame with bolt A (16 pieces) and nut B (16 pieces) using an L-wrench as shown in the picture.
Do not fasten bolts completely here.

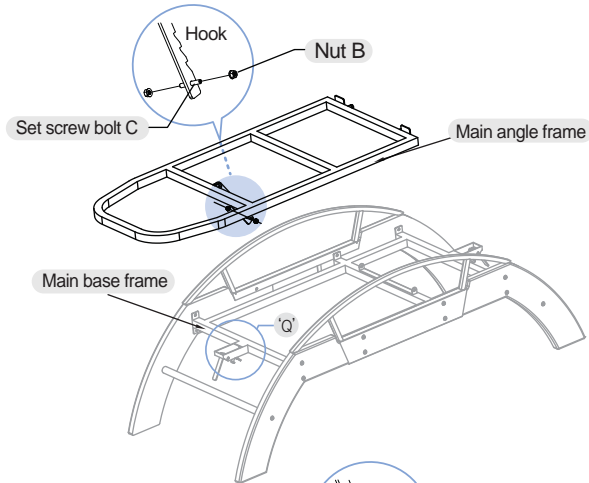
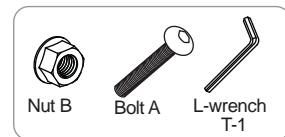

4 How to fix the main angle frame
Place the main angle frame on the base frame as shown in the picture. Fasten a set screw bolt C (1 piece) and nut B (2 pieces) after inserting the hook into 'Q' here.
Completely fasten screws here, which have not been completely fastened in No. 3 assembly sequence.

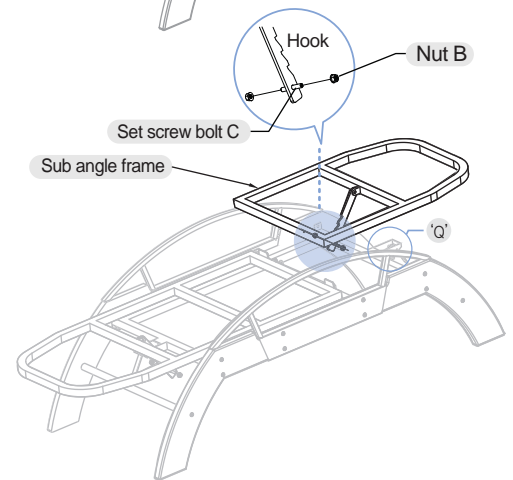
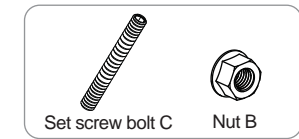

5 How to fix the sub angle frame.
Place the sub angle frame on the base frame as shown in the picture. Fasten a set screw bolt C (1 piece) and nut B (2 pieces) after inserting the hook into 'Q' here.
Completely fasten screws here.

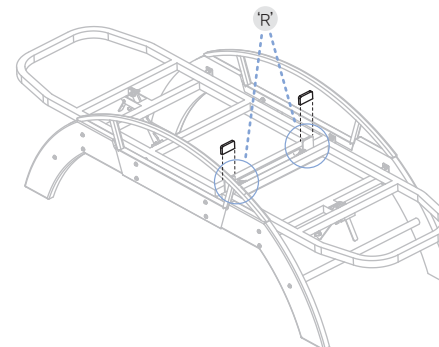
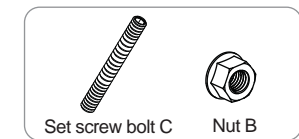

6 Insert the buffer rubbers into 'R' in the picture.
How to insert the buffer rubbers.

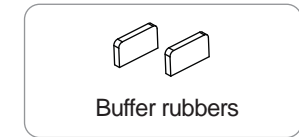

How to Assemble the Product Frame

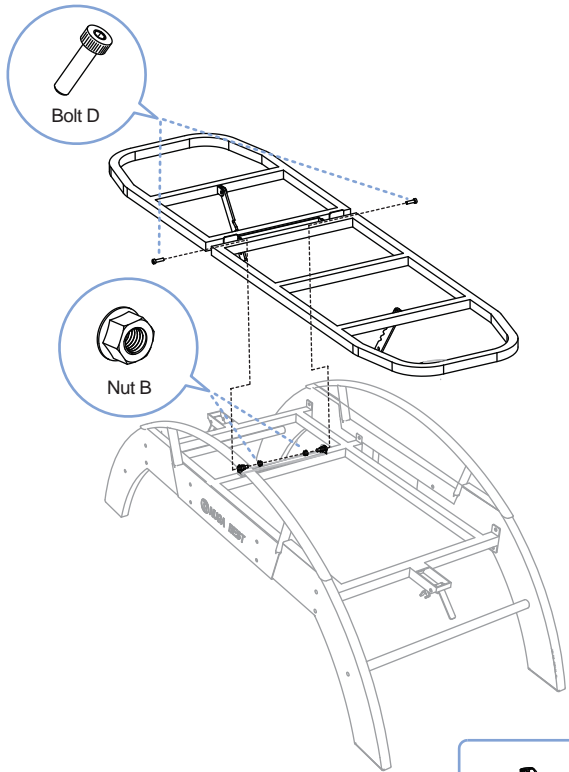

7 How to fix the entirely assembled frame.

Fix the frame by fastening bolt D (2 pieces) and nut B (2 pieces) after setting the main base frame, main frame and sub frame as shown in the picture.

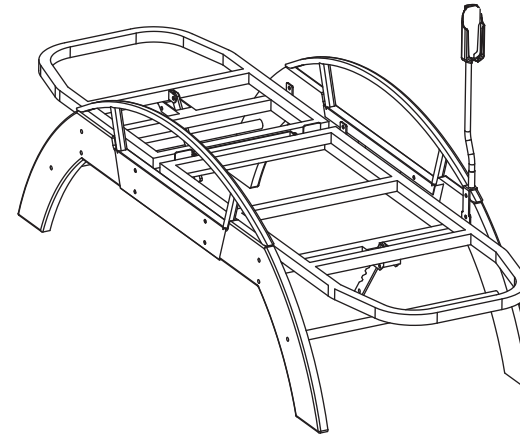
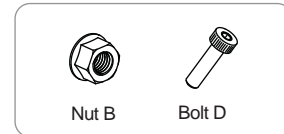

9 How to fix the entire bolts again.

Fasten the entire bolts and nuts tightly once again after the assembly is completed.

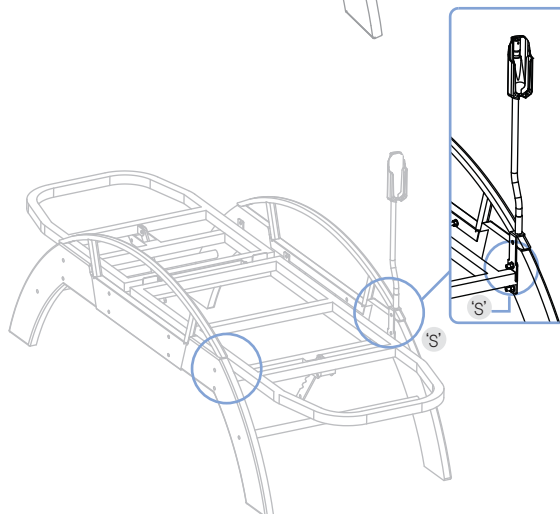

8 How to assemble the remote controller holder.

Fasten bolt A (1 piece) and nut B (1 piece) after inserting the remote control holder into the instructed 'S' position.

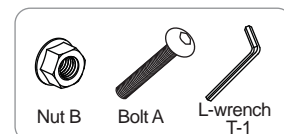

10 Completed appearance

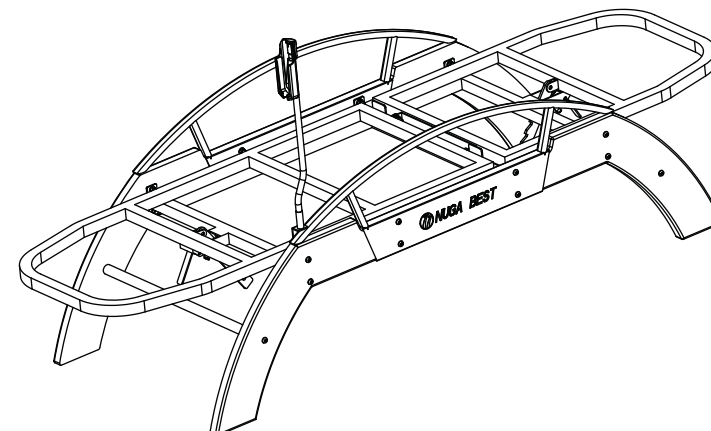

How to Install the Product

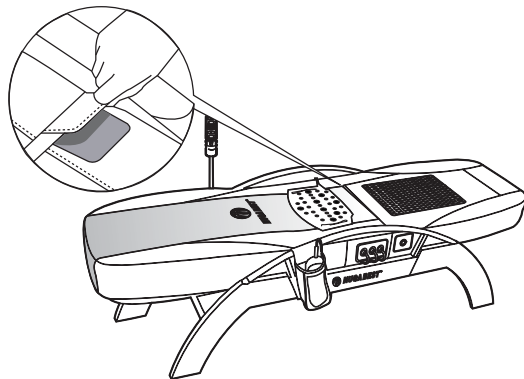

1 Tighten the product frame to the mat

Attach the connecting band after placing and tightening both the main and sub mats to the product frame.

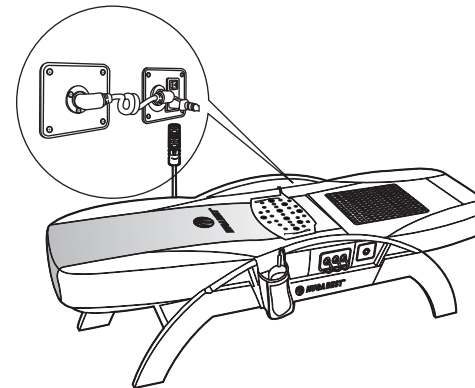

4 Connect the mat cable

Connect the power supply cable for the sub mat to both the main and sub mats as shown in the picture.

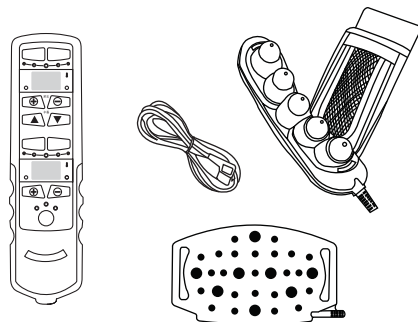

2 Prepare product components

Take out the remote controller, power cord, external projector, projector pocket, and low frequency pad.

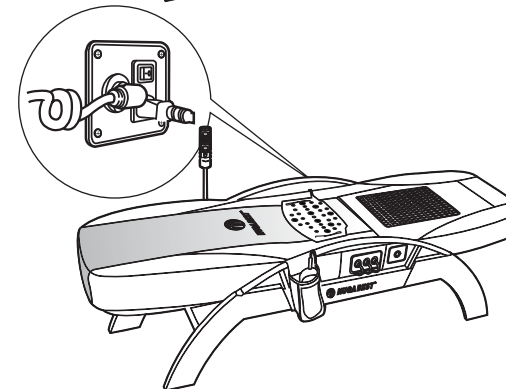

5 Turn on the power supply in the product

Turn on the power switch after the power supply cord is connected to the power input on the side of the main mat.

⚠ Caution

Turn off the power switch when the power is connected. Otherwise, it might cause failure.

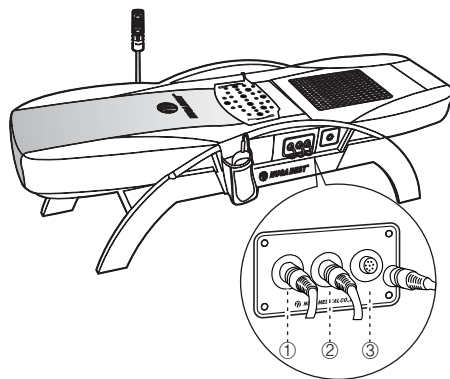

3 Connect to the connector bay

- ① Remote controller
- ② External projector
- ③ Low frequency pad

Connect components sequentially.

⚠ Caution

Keep the groove upward to the cable connection. Malfunctions might occur, if the groove is not aligned accurately during the cable connection.

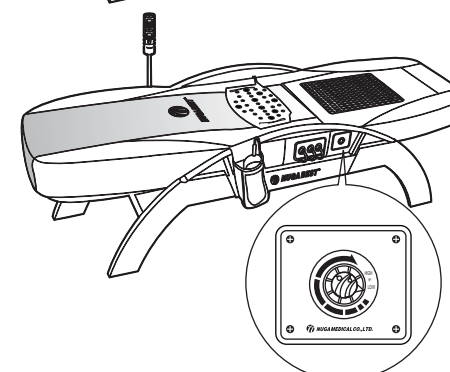

6 Set temperature to the sub heater

Turn the dialer to set the desired temperature in the sub heater attached to the side of the sub mat.

Test Operations after Installation

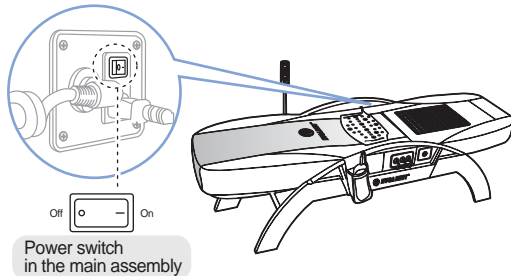

Power switch in the main assembly

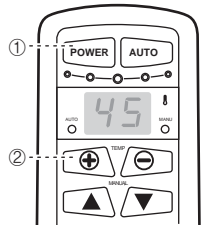

Controller for main assembly

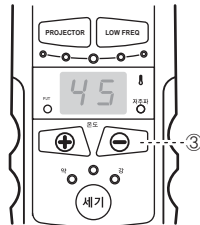

Controller for external projector

1 Check out the power supply for the product

Turn on the power switch.

Caution

Ensure the power supply to be turned off after use or during no use. Otherwise, it might cause failure.

2 Check out operations of remote controller

- ① Press the power button on the remote controller
 - ② Adjust temperature for the internal projector (+ / - button)
 - ③ Adjust temperature for the external projector (+ / - button)
- Refer to 'How to Use the Remote Controller' for each mode (Page 28)

3 Check out operations of sub heater

Turn the dialer to set the desired temperature in the sub heater attached to the side of the sub mat.

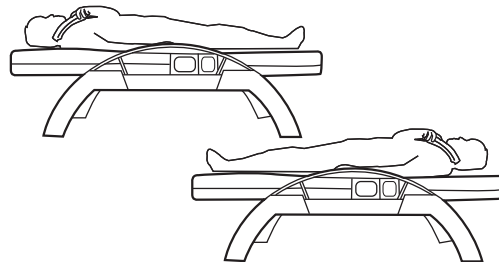
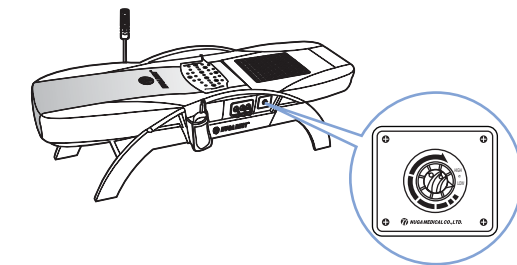

4 Use the product

Lay yourself down with your legs toward the sub mat and press the Auto button in the remote controller for the automatic operations in the product.

You may use the product while laying yourself down the other way around.

NM-5000

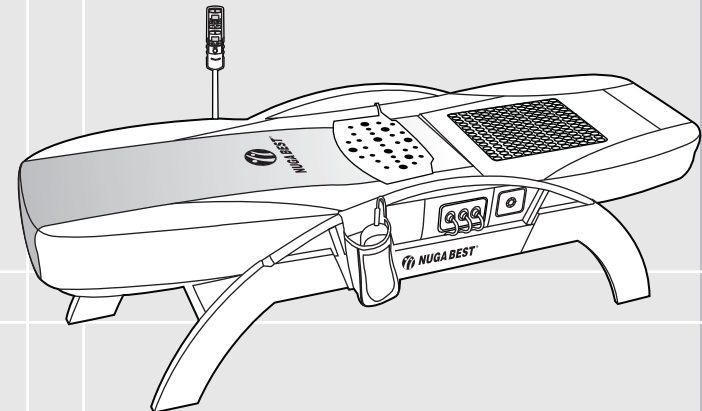

How to Use the Product

How to Use the Remote Controller	28
How to Use the Product by Mode	28
How to Use the External Projector	33
How to Use the Low Frequency Pad	34
How to Use the Product	36
How to Set Temperature for the Sub Heater	38

How to Use the Remote Controller

- How to Use the Product by Mode

Auto ① Mode

Round-trip acupuncture function

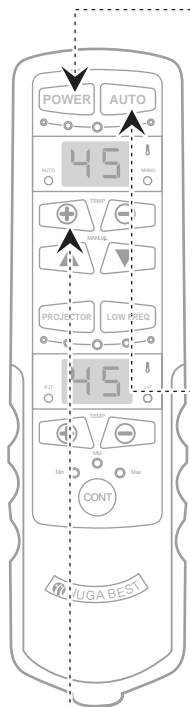

Power supply

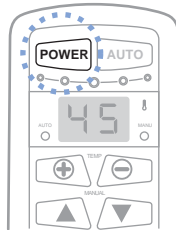

① Press the power button.

- Check out the connecting conditions of the remote controller.
- Press the power button once : On
Press it once again : Off

Auto ① Mode

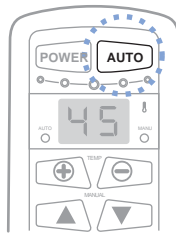

② Press the Auto button to operate the internal projector.
No separate operation is necessary in the middle as the product stops automatically after operations.

The product automatically stops after round-trip acupuncture operations for about 38 minutes.

Temperature control

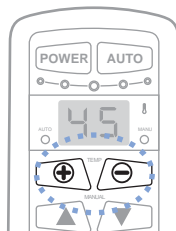

③ Control temperature with +/- button.
(Moderate temperature: 55~60℃)

- Range of temperature setting for internal projector: 40~70℃
- Temperature setting unit
40~55℃: Temperature setting per 5℃
55~70℃: Temperature setting per 1℃

Auto ② Mode

Round-trip massage function

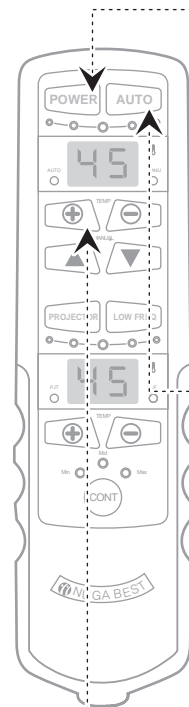

Power supply

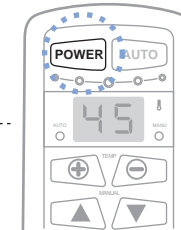

① Press the power button.

- Check out the connecting conditions of the remote controller.
- Press the power button once : On
Press it once again : Off

Auto ② Mode

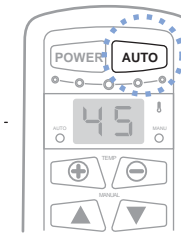

② Press the Auto button twice in a row to operate the internal projector.
No separate operation is necessary in the middle as the product stops automatically after operations.

The product automatically stops after round-trip massage operations for about 38 minutes.

Press the Auto button to operate Auto ② Mode while Auto ① Mode is operating.

Temperature control

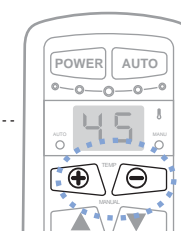

③ Control temperature with +/- button.
(Moderate temperature: 55~60℃)

- Range of temperature setting for internal projector: 40~70℃
- Temperature setting unit
40~55℃: Temperature setting per 5℃
55~70℃: Temperature setting per 1℃

How to Use the Remote Controller

- How to Use the Product by Mode

Auto ③ Mode

Massage function between the thoracic vertebrae and cervical vertebrae

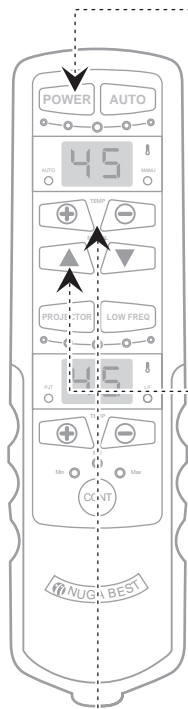

Power supply

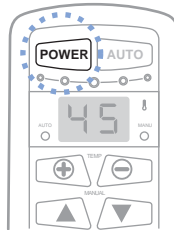

① Press the power button.

- Check out the connecting conditions of the remote controller.
- Press the power button once : On
Press it once again : Off

Auto ③ Mode

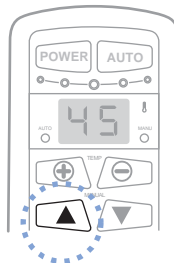

② Press ▲ button twice in a row to operate the internal projector. No separate operation is necessary in the middle as the product stops automatically after operations.

The product automatically stops after round-trip massage operations between the central thoracic vertebrae and cervical vertebrae for about 38 minutes.

Temperature control

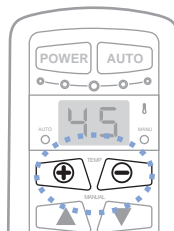

③ Control temperature with +/- button. (Moderate temperature: 55~60℃)

- Range of temperature setting for internal projector: 40~70℃
- Temperature setting unit
40~55℃: Temperature setting per 5℃
55~70℃: Temperature setting per 1℃

Auto ④ Mode

Massage function between the thoracic vertebrae and vertebrae lumbales

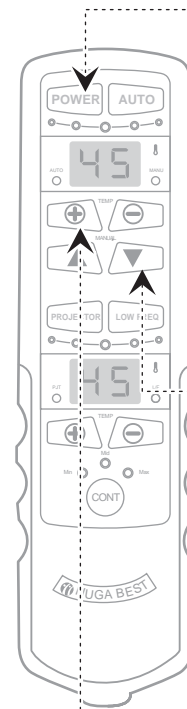

Power supply

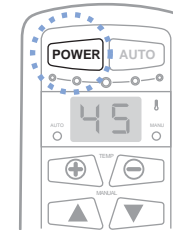

① Press the power button.

- Check out the connecting conditions of the remote controller.
- Press the power button once : On
Press it once again : Off

Auto ④ Mode

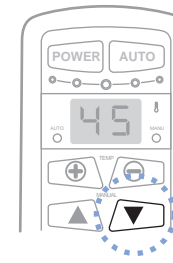

② Press ▼ button twice in a row to operate the internal projector. No separate operation is necessary in the middle as the product stops automatically after operations.

The product automatically stops after round-trip massage operations between the central thoracic vertebrae and vertebrae lumbales for about 38 minutes.

Temperature control

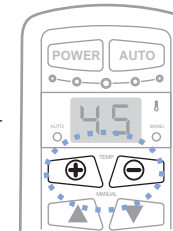

③ Control temperature with +/- button. (Moderate temperature: 55~60℃)

- Range of temperature setting for internal projector: 40~70℃
- Temperature setting unit
40~55℃: Temperature setting per 5℃
55~70℃: Temperature setting per 1℃

Manual Mode

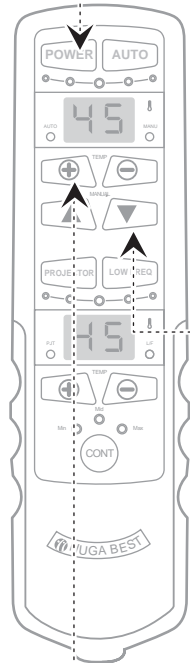

Power supply

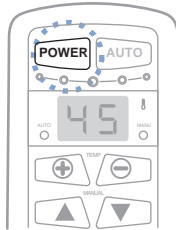

① Press the power button.

- Check out the connecting conditions of the remote controller.
- Press the power button once : On
- Press it once again : Off

Manual Mode

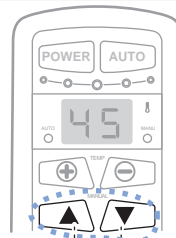

② Use the product after placing the internal projector at the desired position with manual button (▲/▼) during the manual mode. The internal projector moves while (▲/▼) is being pressed.

- ▲: The internal projector moves to the cervical vertebrae.
- ▼: The internal projector moves to the vertebrae lumbales.

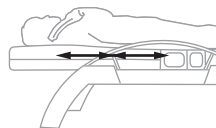

Temperature control

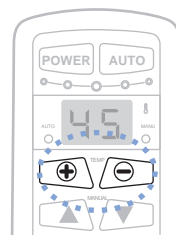

③ Control temperature with +/- button. (Moderate temperature: 55~60 °C)

- Range of temperature setting for internal projector: 40~70 °C
- Temperature setting unit
- 40~55 °C : Temperature setting per 5 °C
- 55~70 °C : Temperature setting per 1 °C

Operations



① Press the projector button.

- Check out the connecting conditions of the projector.
- Press the projector button once: On
- Press it once again: Off

Temperature control

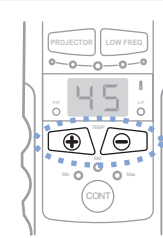

- ② Control temperature with +/- button. (Moderate temperature: 55~60 °C)
- The projector is not turned on if the actual temperature is higher than the setting temperature, which is not meant to be any failure.
 - Temperature setting unit
 - 40~55 °C : Temperature setting per 5 °C
 - 55~70 °C : Temperature setting per 1 °C

Applied to the specific area

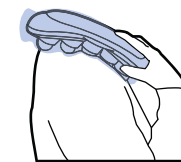

③ Apply to the desired area.

- Put the projector covers on before applying it.

Caution

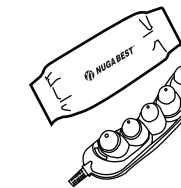

④ Ensure the projector covers to be covered while the external projector is being used.

- Be aware that any direct contact from the projector to the skin during the high temperature setting might cause burns.

How to Use the Remote Controller

- How to Use the Low Frequency Pad

Connection

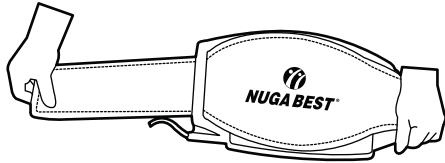

What is the low frequency pad?

The low frequency pad is a device to improve scleritic pain or amyotrophia by applying weak current to the human body.

① Connect an abdominal band to the hole in both sides of the low frequency pad.



Towel for the low frequency pad

② Wear the low frequency pad and abdominal band after wetting the towel for the low frequency pad or a piece of 100% cotton towel or cloth with water, and placing it on the belly before wearing the low frequency pad, if there is no gel at home.

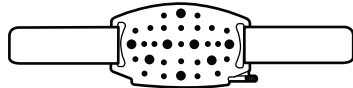

Surface to contract the belly

Use a piece of towel or cloth after squeezing it out completely to prevent it from flowing water when it is wetted with water.



③ Wear the abdominal band after fixing the low frequency pad in a good manner.

Various wearing methods

You may wear it around any area other than the abdominal area.



Power supply

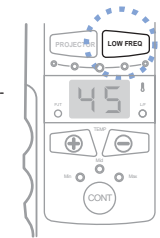

④ Press the low frequency button to turn on the power supply for the low frequency pad. (Initial setting is set to 'Weak 1'.)

- Check out the connecting conditions of the low frequency pad.
- Press the low frequency button once: On Press it once again: Off

Strength control

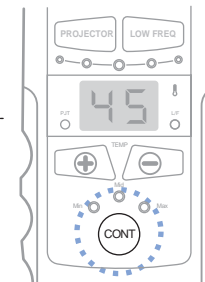

⑤ Control the strength of low frequency with the strength button. (Refer to the following.)

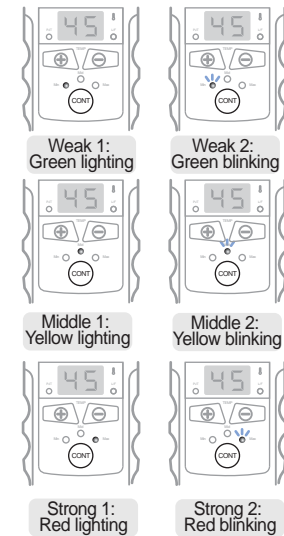

The low frequency pad automatically stops after operations for about 40 minutes.

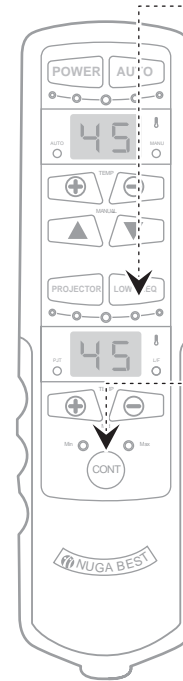

How to Use the Product

Basic use

Normal direction

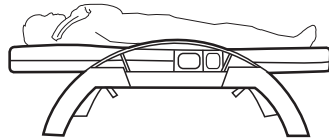

Reverse direction

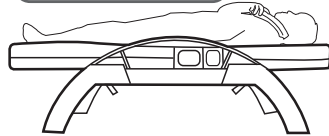

- ① Lay yourself down with the head to the main mat and legs to the sub mat.
- ② Apply massage to your desired area such as your arms with the external projector during the Auto mode.
- ③ Use the product while you are laying yourself down to the opposite side.

⚠ Caution

Ensure using the projector covers while applying the external projector. Be aware of burns if the product is applied to a part in the human body for a long time.

How to control angle

Control angle in 10°, 20° or 30°
Angle control can be done to both directions.

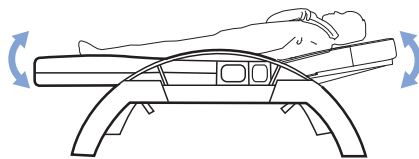

- ① Stepwise control by 10° can be done with 10°, 20° or 30° if the mat angle is set upward.
 - Grab the product frame at the mat bottom and then control stepwise to set upward.
- ② Pull down attached to the product frame if you want the mat angle downward.

Set angle upward

Set angle downward

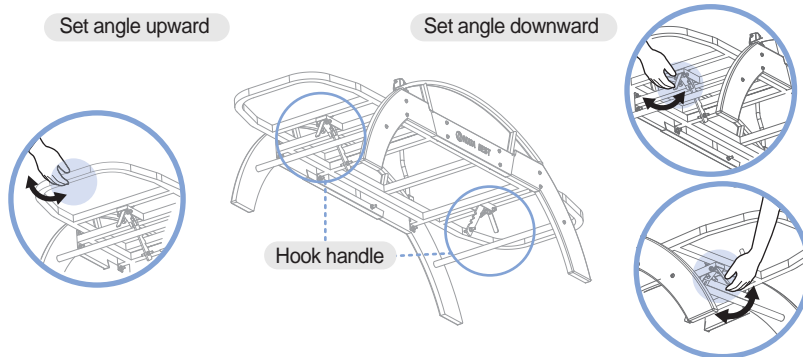

How to use while sitting

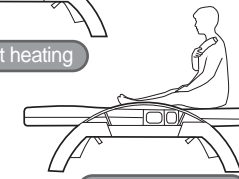
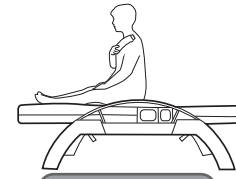

- ① Apply massage with the external projector after operating the product in the same way as the basic use.
- ② Use the product after controlling temperature for the sub mat while operations for the main mat is being stopped.

⚠ Caution

Ensure using the projector covers while applying the external projector. Be aware of burns if the product is applied to a part in the human body for a long time. Apply the proper temperature while using the sub heater.

Simultaneous use for 2 persons

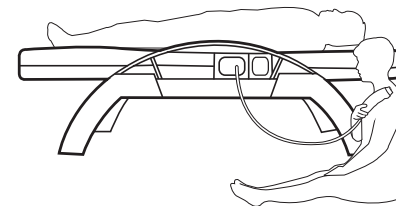

- ① Two persons can use the product simultaneously with one person on the product and another person with the external projector while sitting.

⚠ Caution

Ensure using the projector covers while applying the external projector. Be aware of burns if the product is applied to a part in the human body for a long time.

How to apply to the abdominal area

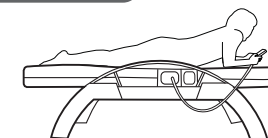
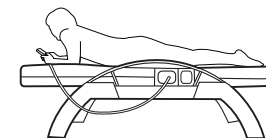

- ① Lie on your face with the head to the main mat and legs to the sub mat.
- ② Press the button with the remote controller to move the internal projector to the abdominal area. Lie on your face after moving to the abdominal area.
- ③ Apply the heating function to the abdominal area using the sub heater while laying yourself down to the opposite direction. Stop operating the main mat during this time.

⚠ Caution

Do not apply the product to the breast but only to the abdominal area manually during massage to the abdominal area. Otherwise, it might cause damage to the human body.

How to Set Temperature for the Sub Heater

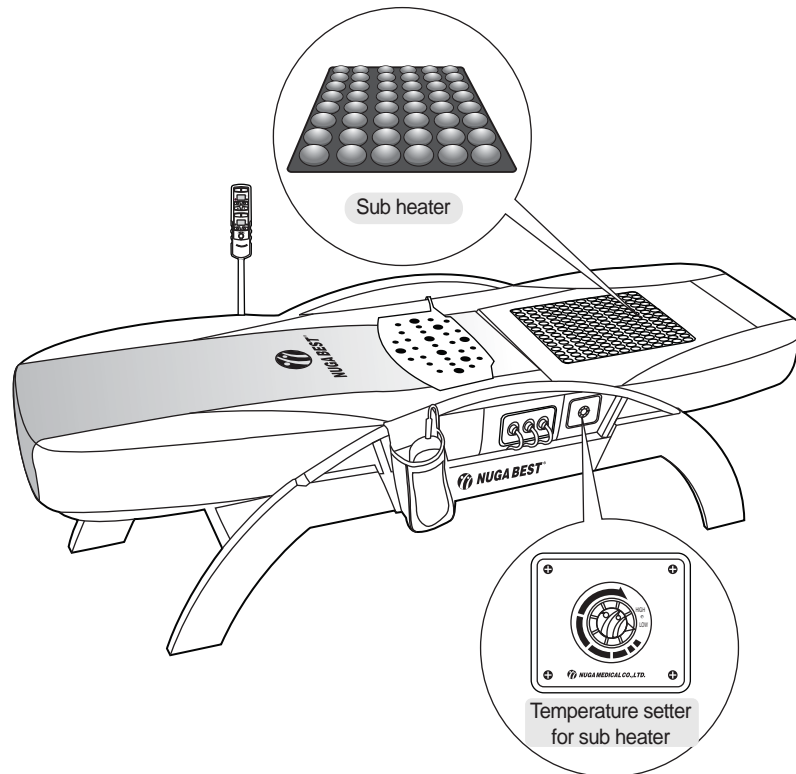

How to use temperature setter for sub heater

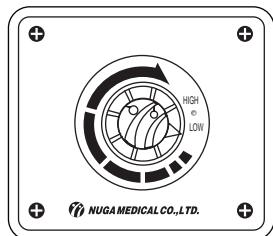

Turn the dial to the desired position to set temperature.
(30~65°C)

NM-5000

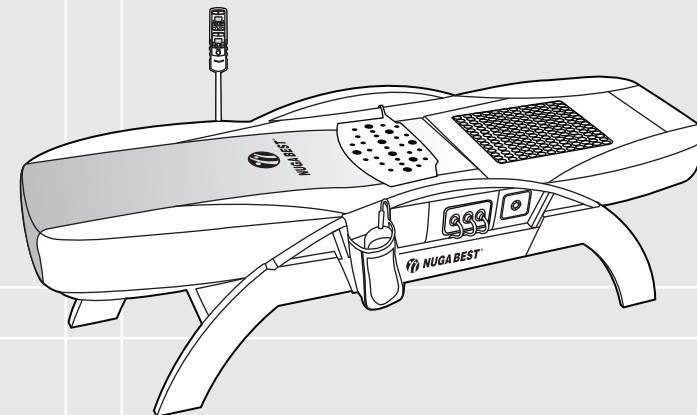

Product Storage and Care

How to Store and Clean the Product after Use	40
Check Indicator Window of Remote Controller	41
How to Take Emergency Actions during Use	42
Self-check Items	43
Before any A/S Request	44
Product Specifications	45
Memo	46
Product Warranty	47

How to Store and Clean the Product after Use

Check Indicator Window of Remote Controller

i Introduction

1. Separate the power cord while the product is not being in use for a long time.
2. Be aware of the following for the storage place.
 - ① Keep the product in a place with no water.
 - ② Keep the product in a place with no concern of any adverse effect such as the air pressure, temperature, humidity, ventilation, sunlight and/or air containing dust, salt, sulfur, etc.
 - ③ Be careful of safety conditions such as the slope, vibration, shock, etc. (including those during transportation).
 - ④ Do not keep the product in a place to store any chemical or gas.
 - ⑤ Avoid any direct sunlight during the storage.
3. Store the product after arranging components clean.

Environmental conditions

- During operations : Temperature (0~35℃), humidity (20~80%)
- Transport and storage conditions : Temperature (-10~40℃), humidity (20~80%), atmospheric pressure (700hPa to 1060hPa)

How to clean



Caution

Ensure unplugging the power plug before cleaning. Otherwise, it might cause electric shocks.

Mat cover

Wipe out the mat cover with wax for leather seat or dry cloth.

External cloth
Separate and clean the external cloth.

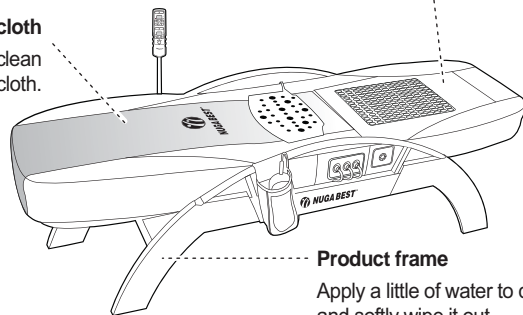

Product frame

Apply a little of water to dry cloth and softly wipe it out.



Caution

Do not disassemble the product arbitrarily if any error occurs, but remove the power plug, turn off the power switch, and then contact your supplier. If you disassemble the product arbitrarily, it might cause serious injuries and/or damage to the product.

Display	Descriptions	Display location
	Abnormal temperature sensor in the internal projector	Indicator window for the internal projector conditions
	Disconnection of lamp in the internal projector	Indicator window for the internal projector conditions
	Abnormal temperature sensor in the external projector	Indicator window for the external projector temperature
	Disconnection of lamp in the external projector	Indicator window for the external projector temperature
	Disconnection of the upper or lower limit switch	Indicator window for the internal projector conditions

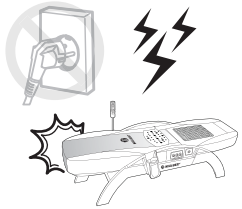

Stop using the product immediately and remove the power plug if there is any lightning.



Stop using the product immediately and contact your supplier branch or our company if you smell any burn or detect any smoke from the product.



Stop using the product immediately and consult with a doctor if any abnormality occurs from the human body.

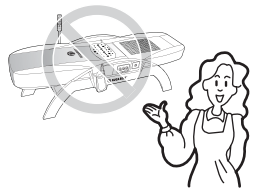

Turn off the power switch immediately, stop using the product and contact our company if you find out any failure or power failure from the product.

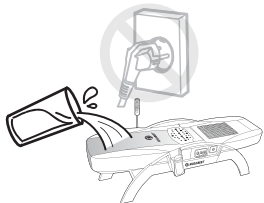

Turn off the power switch, remove the power plug immediately, and then contact our company if you pour water into the water.



Caution

There might be concerns of injuries or fire if you fail to check out the following. Make sure that you check out the following.

Check before use

1. Is the power cord connected to a socket? Yes No
2. Is the remote controller operating well? Yes No
3. Is the temperature indication displayed on the temperature indicator window on the remote controller? Yes No
4. Is the temperature of the projector not too high? Yes No
5. Is the temperature of the sub heater not too high? Yes No
6. Is the power supply for both the internal and external projectors turned on? Yes No
7. Did you check out conditions for any damage to the power cord or cable conditions? Yes No

Check after use

1. Is the temperature on the temperature indicator window on the remote controller turned off? Yes No
2. Is the operating lamp on the remote controller turned off? Yes No
3. Is the power lamp on the projector turned off? Yes No
4. Is the power switch turned off to the point? Yes No
5. Is the power cord separated from the socket? Yes No



Caution

Ensure checking out the following before applying for A/S if any abnormality occurs from the product.
The product might fail to operate normally even without any failure if you use it with no right understanding on how to use it.

Checklist for any abnormality on the remote controller

If various indicator lamps on the remote controller are not operating;	<ol style="list-style-type: none"> ① Turn on the main power switch. ② Check out if the power cord is accurately connected. ③ Check out if the fuse inside the main power switch is disconnected. ④ Check out if other operating keys are pressed on the remote controller.
If you see a warning message "1E";	<p>It is a safety message due to failure in the heating lamp for the internal projector.</p> <p>The product will operate if you replace the heating lamp. Do not disassemble the product but contact your nearest supplier or A/S center.</p>
If you see a warning message "3E";	<p>It is a safety message due to failure in the heating lamp for the external projector.</p> <p>The product will operate if you replace the heating lamp. Do not disassemble the product but contact your nearest supplier or A/S center.</p>

Checklist for any abnormality on the internal projector

If the internal projector is not operating;	<ol style="list-style-type: none"> ① Check out if the power cord is accurately connected. ② Connect the connector for the remote controller again. Do not disassemble the product but contact your nearest supplier or A/S center.
---	--

Checklist for operations of the low frequency pad

If the low frequency pad is not operating;	Check out if the connector for the low frequency pad is connected accurately.
--	---

Product name and model name	Thermal massage bed NM-5000
Manufacturer	NUGA MEDICAL CO., LTD. 185, Jiraeul-ro, Jijeong-myeon, Wonju-si, Gangwon-do, Korea
Date of manufacture / number of manufacture	Marked on the product
Product weight	Main box: 31 kg Subsidiary box: 13 kg Product frame box: 35 kg
Product size	Main mat: 1220 X 615 X 170 (mm) Sub mat: 790 X 610 X 147 (mm) Product frame: 1980 X 655 X 560 (mm)
Cautions during use	Refer to the user manual
Operating method	Refer to the user manual
Electric rating	AC 220~240V~, 50~60Hz
Power consumption	250 W

Product Warranty

Company	Product name	
	Model name	
	Warranty period	1 year from purchase
	Date of purchase	
Customer	Place of purchase	
	Phone	
	Name of customer	
	Customer number	
	Address	

- ※ Please keep this warranty carefully. You can receive sufficient service only by presenting this warranty with the place and the date of purchase.
- NUGA Medical Co., Ltd. provides warranty of this product according to the regulations of the Consumer Protection Act.
 - Contact your local sales retailer or NUGA Medical office when the product is damaged.
 - The spare parts of this product are secured for 3 years after this product is discontinued.
 - You must have the place of purchase written in the warranty at the time of your purchase in order to receive warranty repairs.
1. The warranty is valid until 1 year from the date of purchase and only damages caused during normal operation are subject for warranty repairs.
 2. The warranty period of this product is calculated from the date of purchase, and therefore have the store of purchase record the date of purchase on your warranty when you purchase the product (When the date of purchase cannot be verified, the warranty period is added from the day after 6 months from the date of manufacture).
 3. When this product is used for commercial purposes (e.g., used for sales, in abnormal environment, etc.) or for industrial purposes, the warranty period is reduced to 6 months. (including essential spare parts)
 4. This warranty cannot be reissued.
- ※ Warranty repair is not provided in the following cases.
- When damage is caused by natural disasters (e.g., fire, earthquake, flood, and wind)
 - When replacing consumptive parts that normally wear from use
 - When damage is caused by an abnormal power source or faults in a connecting unit.
 - Other external reasons other than faults of the product itself.
 - When damage is caused by repairs or modifications done by a person who is not a certified repair personnel of NUGA Medical's local office or service center.

NUGA MEDICAL CO., LTD.
<http://www.nuga.kr>